

Experience the freedom to explore, without limitations.

DISCOVER THE GLADIATOR POD >



Designed for rugged exploration, the Gladiator Pod seamlessly integrates with your ute, enabling next-level off-grid adventuring!

Meet the new way to explore New Zealand: from the deck of your ute!

Whether you're planning an urban escape, a nature retreat, or a cross-country road trip, **make your next adventure extraordinary with the all-new Gladiator Pod.**

Table of contents

This brochure is intended as a product overview of the Gladiator Pod. Some information may be subject to change from time of publication and dependent on stock availability.

- 4 Exterior overview
- 6 How to mount to your ute
- 7 Vehicle compatibility
- 8 Interior overview
- 10 Colour palettes
- 12 Model specifications
- 13 Optional add-ons and upgrades
- 14 Get your Gladiator Pod



Key design features

OFFROAD CAPABLE

Goes where your ute goes. Light weight, sturdy and compact, the Gladiator Pod is ready for river crossings, mud, and anything you can throw at it.

BUILT TO LAST

Ergonomic monoblock fiberglass body. Rust-proof, leak-proof and non-flammable, with antibacterial protection.

QUICK-MOUNT SYSTEM

Extremely portable with an easy mounting on-and-off system.

WELL INSULATED

Quality insulation guarantees a comfortable night's sleep - whether in the warmer or cooler months.

COMPATIBLE WITH MOST UTES

Compatible with most double-cab utes. Check page 7 for more information about compatibility.

HIGH-IMPACT RESISTANT

High-strength fibre-reinforced composite exterior shell which proves high-impact, dent and crack resistant.



Quality exterior shell for all-round protection

Robust, lightweight and a complete monocoque unit, the Gladiator Pod's outer shell is a sturdy framework that will make you feel safe and secure in the toughest locations.



Lightweight, lasting durability to get you anywhere, safely.

The fiberglass monocoque shell provides high chemical and mechanical strength, as well as a flexible structure to eliminate any kind of infiltration for a seamless period of time.

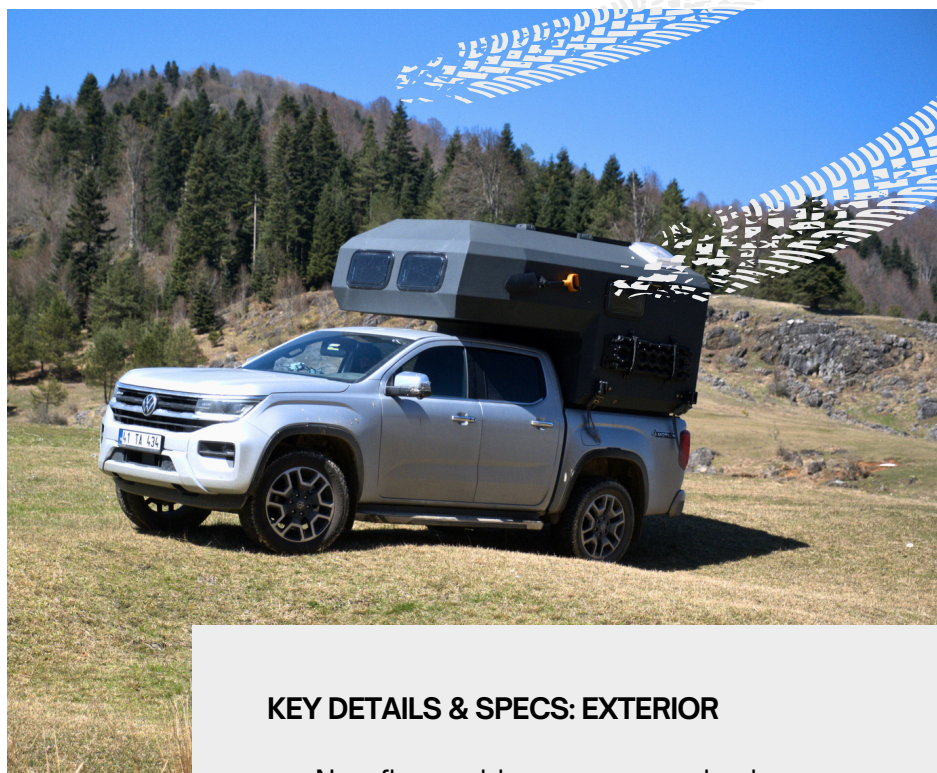

KEY DETAILS & SPECS: EXTERIOR

- Non-flammable monocoque body
- Pod weight from 490kg
- Total width 1870 mm*
- Total length 2900 mm*
- Total height 2200 mm*
- Clean water tank 58 litres
- Waste water tank 23 litres

*DIMENSIONS ARE EXCLUDING EXTRAS

[SEE PAGE 12 FOR FULL SPECS](#) ➔

ANTIBACTERIAL SHELL

The antibacterial feature of the cabin stops any bacteria growth and formation.

SNUG FIT ON THE UTE DECK

Designed to fit inside your ute's well-side so that you don't have to have the tailgate down or removed.

OPTIONAL ADD-ON: ADVENTURE PACK

Planning an adventure? The Adventure Pack includes a hatchet, spade and recovery boards (as depicted right).

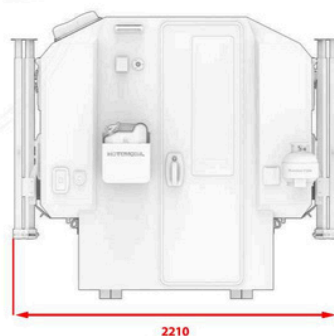
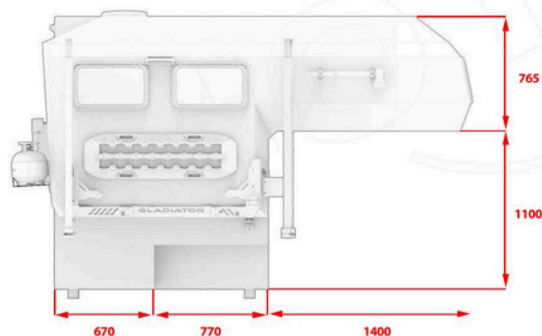
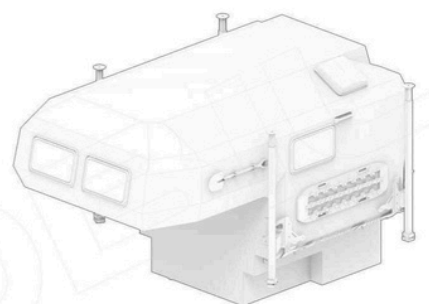
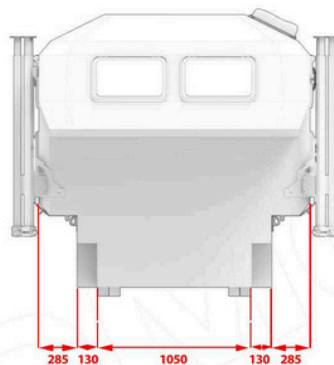
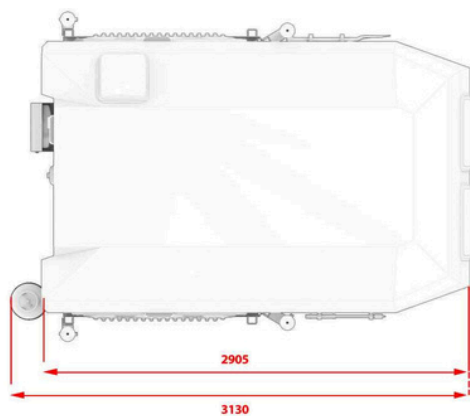

QUICK-MOUNT SYSTEM

Extremely portable with an easy mounting on-and-off system.

See following page.



Make the most of your ute

Got a ute? Get the other half! The Gladiator Pod is expertly designed to integrate with your ute without affecting your vehicle's off-road performance and mobility. Explore like never before.

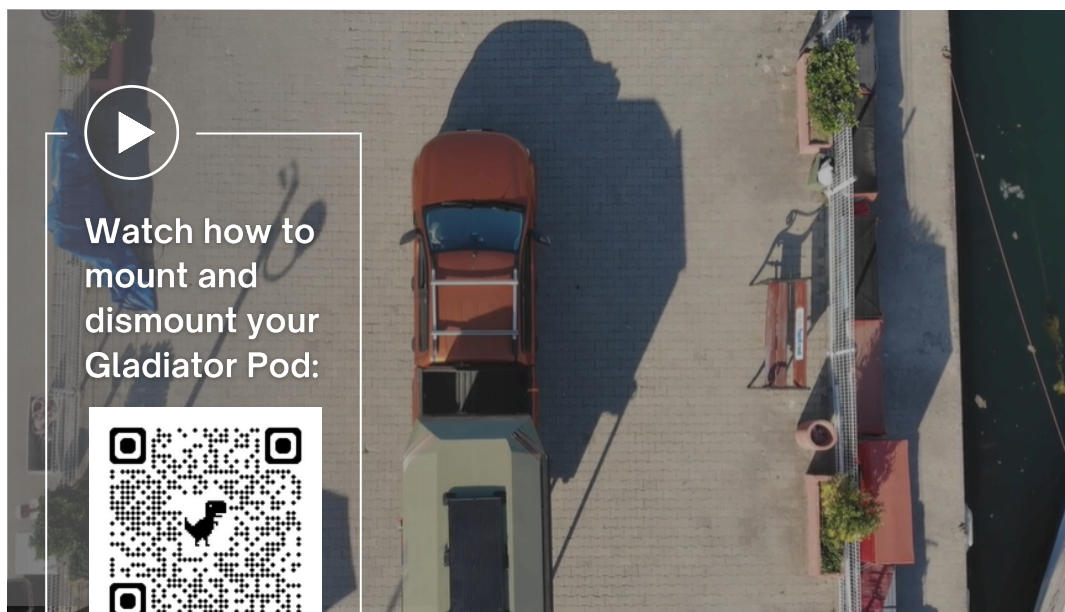

Watch how to
mount and
dismount your
Gladiator Pod:



Visit www.campro.wistia.com/medias/azslz7jg2b

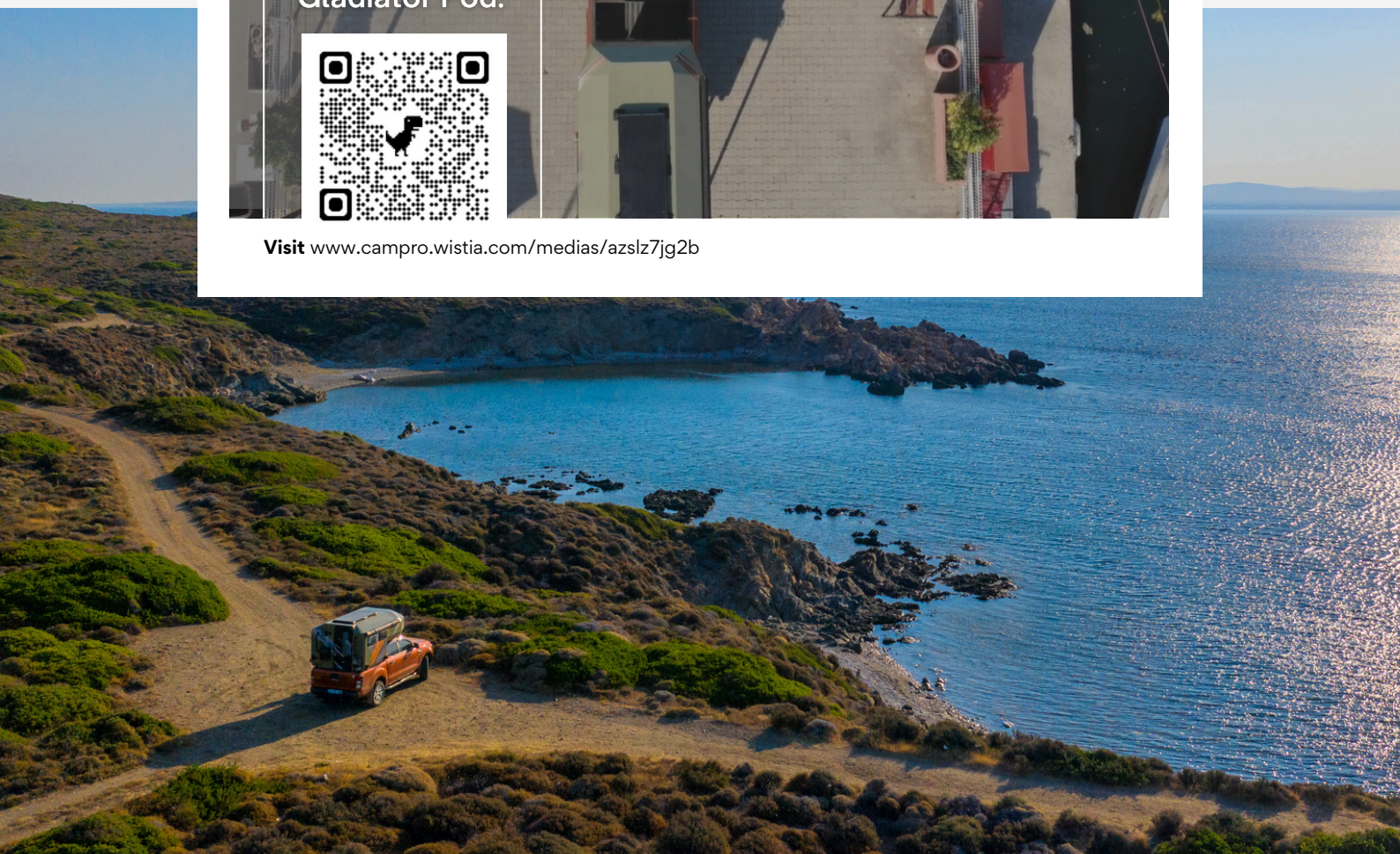



Common ute decks that are compatible with the Gladiator Pod:

✓ Ford Ranger

✓ Mazda BT-50

✓ Jeep Gladiator

✓ LDV T60

✓ Isuzu D-Max

✓ Holden Colorado

✓ Toyota Hilux

✓ Mercedes-Benz X-Class

✓ Nissan Navara

✓ Mitsubishi Triton

✓ VW Amarok

**Can't see
your ute on
our list?**

Get in touch to discuss
special request Gladiator
Pod XL options.

INTERIOR OVERVIEW

A simple and compact design, yet surprisingly spacious...

Dine and sleep in comfort, even if you're in the middle of nowhere.

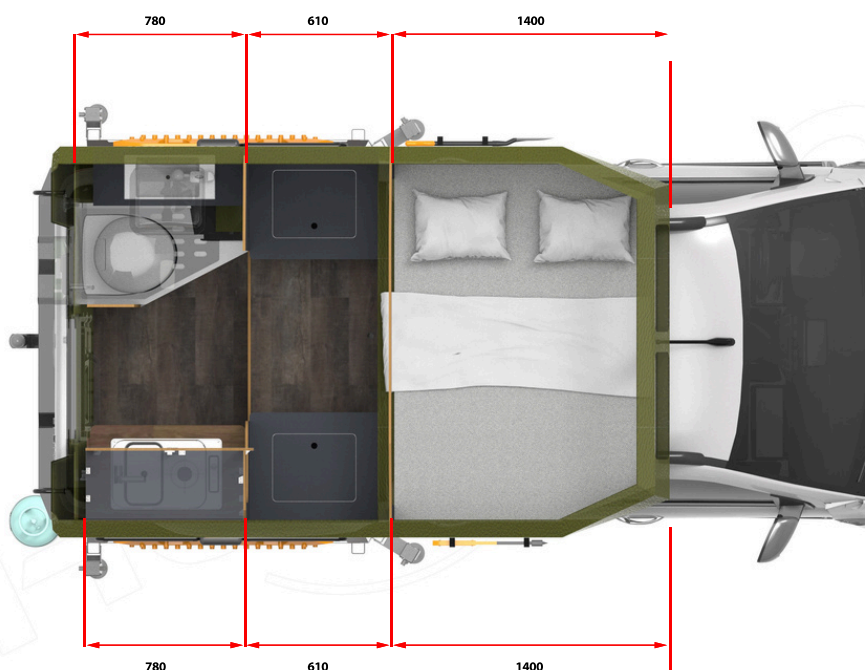
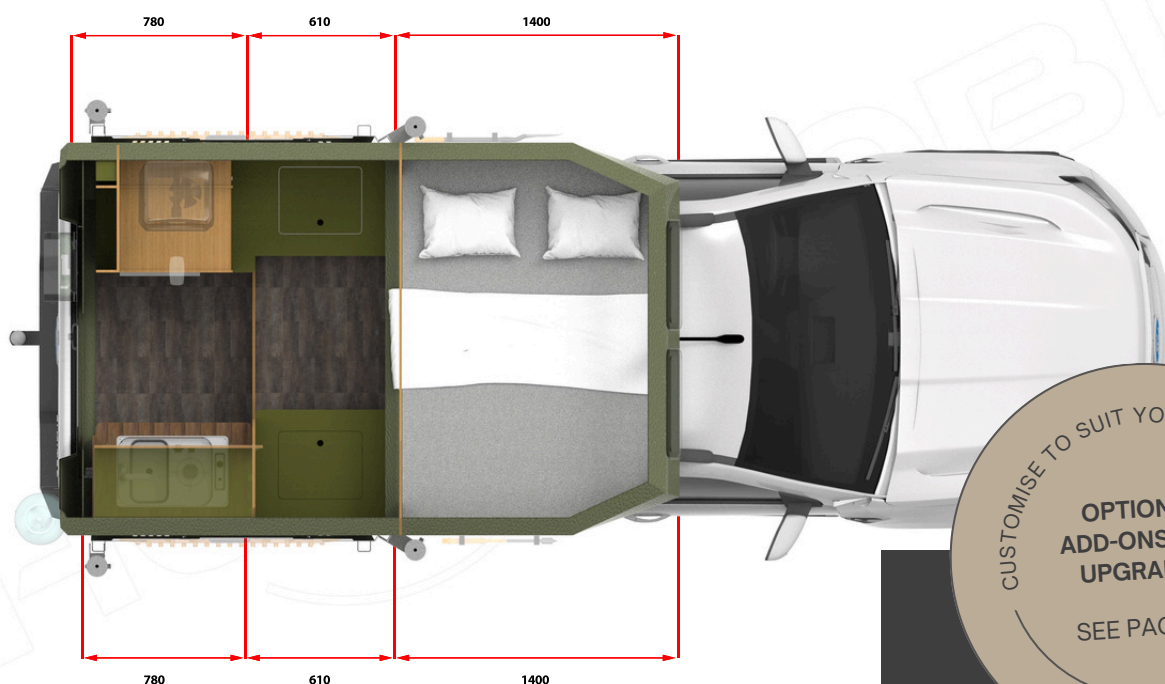

CUSTOMISE TO SUIT YOURSELF
OPTIONAL
ADD-ONS AND
UPGRADES
SEE PAGE 13

**Choose from
two floor plans:**

- 1** Without a bathroom unit (as depicted top)
- 2** With a bathroom unit (as depicted bottom)



CABIN SPECIFICATIONS

- Interior Height 1820 mm
- Bed Capacity 2 (5 Optional)
- Bed Sizes 180 x 135 cm
- King Size Bed optional

SEE PAGE 12 FOR FULL SPECS ➤



All-year-round comfort with great insulation properties

Summer, autumn, winter and spring... whatever the weather, hit the road! Your Gladiator Pod is **well insulated with monoblock technology to keep the inside cabin temperature consistent in both warmer or colder months.**

The moderate and premium models feature 20mm high-density polyurethane insulation in the cabin walls, creating a thermos affect condition, which prevents heat transfer from the inside to the outside and reverse.



Choose from a variety of colour palettes

Carefully chosen exterior and interior colours give the Gladiator Pod a stylish edge. Exterior and interior colour combinations are imported pre-selected. Get in touch to discuss custom colour combinations.

Exterior swatches



Interior swatches

- 1 Furniture 2 Cabinetry 3 Benchtops 4 Edge band

SIS

AVAILABLE

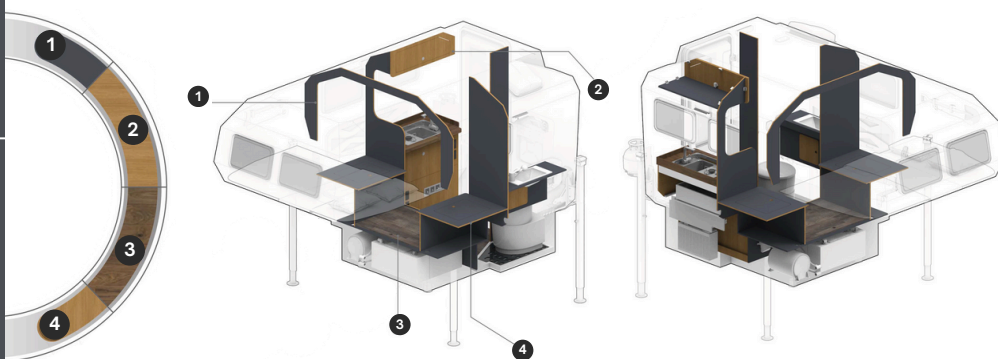

SEDEF

AVAILABLE

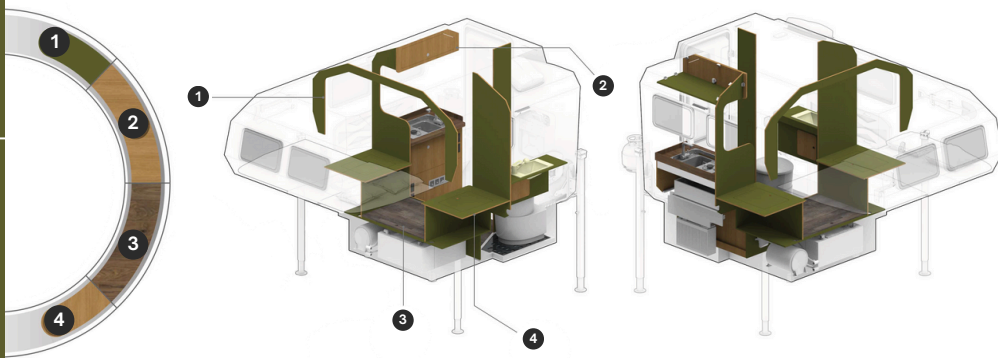

MANDARIN

AVAILABLE

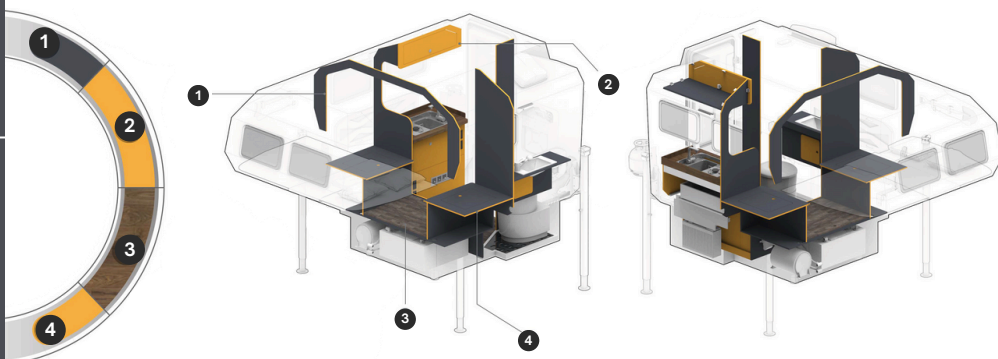

Full specifications and package details

Complete packages as detailed below are available to order now. We cannot guarantee immediate fulfilment - this is dependent on our current stock and that of our supplier.

FEATURE	CHOOSE FROM THREE GLADIATOR POD MODELS:		
	BASIC MODEL	INTERMEDIATE MODEL	ADVANCED MODEL
Interior Concept	Minimalist	Luxury Design	Luxury Design
Furniture	12mm MDF laminate (without edge banding)	Laminate on counter	Laminate on counter
Body	Monocoque	Monocoque non-flammable body	Monocoque non-flammable body
Insulation	5mm	20mm	20mm
Eberspacher Diesel Hot Water System	OPTIONAL UPGRADE	OPTIONAL UPGRADE	OPTIONAL UPGRADE
Eberspacher Diesel Air Heater System	Standard	Standard	Standard
Service Battery	55AH GEL	100AH AGM	100AH AGM
Solar Energy System	-	190 W MPPT 20A	205 W MPPT 30A
Inverter	OPTIONAL UPGRADE	OPTIONAL UPGRADE	Linetech 1000W
Control Panel	Manual	CBE 100 Electronic	CBE 180 Electronic
12V Socket and USB Port	Standard	Standard	Standard
Entrance Door Lighting - LED	-	Standard	Standard
External Lighting Packet	-	1 Unit	2 Units
Interior Lighting Packet	2 LED Lights	2 Reading Lamps + 3 Extra Lights + Led System	2 Reading Lamps +3 Extra Lights + Led System
Gas Sensor	Standard	Standard	Standard
Outdoor Shower System	Standard	Standard	Standard
Fresh Water Tank	58 Lt	58 Lt	58 Lt
Waste Water Tank	23 Lt	23 Lt	23 Lt
Windows Living Area (2 x)	Basic	Swatter and sun-blinded	Swatter and sun-blinded
Window - Kitchen	-	Swatter and sun-blinded	Swatter and sun-blinded
Windows- Bedroom (2 x)	Basic	Swatter and sun-blinded	Swatter and sun-blinded
King Size Bed 200cmx170cm	-	Standard	Standard
Kitchen	Basic	Sink,1 burn stove (Foldable), tap	Sink,1 burn stove (Foldable), tap
Bathroom - Toilet, Basin, Cupboard	OPTIONAL UPGRADE	OPTIONAL UPGRADE	OPTIONAL UPGRADE
Ceiling Vent	OPTIONAL UPGRADE	OPTIONAL UPGRADE	OPTIONAL UPGRADE
12V Compressor Fridge	Standard	Standard	Standard
Roll-out Awning - 220 x 240cm	OPTIONAL UPGRADE	Standard	Standard
Adventure Pack - Hatchet, Spade, Recovery Boards	OPTIONAL UPGRADE	OPTIONAL UPGRADE	OPTIONAL UPGRADE
Roof Tent - Sleeps 2	OPTIONAL UPGRADE	OPTIONAL UPGRADE	OPTIONAL UPGRADE
Camper Jacks (4 x)	Standard	Standard	Standard



Get in touch to discuss pricing for all Gladiator Pod models and optional upgrades. See following page for how to enquire and order.

OPTIONAL ADD-ONS

Customise your adventure

Take it to the next level with our optional add-ons and upgrades.

All upgrades are on request, so get in touch to enquire.



ROOF TENT



AWNING



BATHROOM PACKAGE



INVERTER



ROOF VENT



ADVENTURE PACK



EBERSPACHER HYDRONIC WATER HEATER



Place your order today!

STEP

1



Start the chat!

Scan the QR code to the right to send us an initial message about your enquiry.

Visit: www.forms.onepagecrm.com/66148c317241d1696793d908/

STEP

2

We'll get in touch with you to discuss your request and the current availability.

If you would like to order a Gladiator Pod that we already have in stock we will arrange shipping at a near date. If you would like a custom-designed Gladiator Pod with a selection of our available add-ons, we will get to work and keep you updated along the way.

STEP

3

Order placed and payment agreement

Choose from a variety of payment options.

STEP

4

We prepare your Gladiator Pod

Along with any of your selected customisations.

STEP

5

Your Gladiator Pod is delivered ✨

We'll provide you with a quick-start guide to get you started - then you can hit the road!

GET IN TOUCH

Got questions?

We'd love to hear from you! Get in touch with us today and book a consultation to learn more about the Gladiator Pod.



enquiries@campro.co.nz



0800 444 250



www.campro.co.nz/gladiatorpod



Imported by Campro Industries
35 Packham Crescent
Stoke, Nelson 7011



Get out there and
explore our beautiful
country.

Ute life chose you.



35 PACKHAM CRESCENT, STOKE, NELSON 7011
ENQUIRIES@CAMPRO.CO.NZ
